



FLEX WORKTOP

Assembly Instructions

Models

GANA24HWMX - Wood Tone

Modèles

GANA24HWMX - Ton Du Bois

Modelos

GANA24HWMX - Tono Madera

PLAN DE TRAVAIL FLEX

Instructions d'assemblage

ENCIMERA FLEX

Instrucciones de montaje

TABLE OF CONTENTS/TABLE DES MATIÈRES/TABLA DE CONTENIDOS

WORKTOP SAFETY	2	SÉCURITÉ DU PLAN DE TRAVAIL ...	5	SEGURIDAD DE LA ENCIMERA.....	8
DIMENSIONS	2	DIMENSIONS	5	MEDIDAS	8
INSTALLATION INSTRUCTIONS	3	INSTRUCTIONS D'INSTALLATION...	6	INSTRUCCIONES DE	
WARRANTY	4	GARANTIE	7	INSTALACIÓN	9
				GARANTÍA	10

WORKTOP SAFETY

Your safety and the safety of others are very important.

We have provided many important safety messages in this manual and on your appliance. Always read and obey all safety messages.



This is the safety alert symbol.

This symbol alerts you to potential hazards that can kill or hurt you and others.

All safety messages will follow the safety alert symbol and either the word "DANGER" or "WARNING."

These words mean:

⚠ DANGER

You can be killed or seriously injured if you don't immediately follow instructions.

⚠ WARNING

You can be killed or seriously injured if you don't follow instructions.

All safety messages will tell you what the potential hazard is, tell you how to reduce the chance of injury, and tell you what can happen if the instructions are not followed.

DIMENSIONS

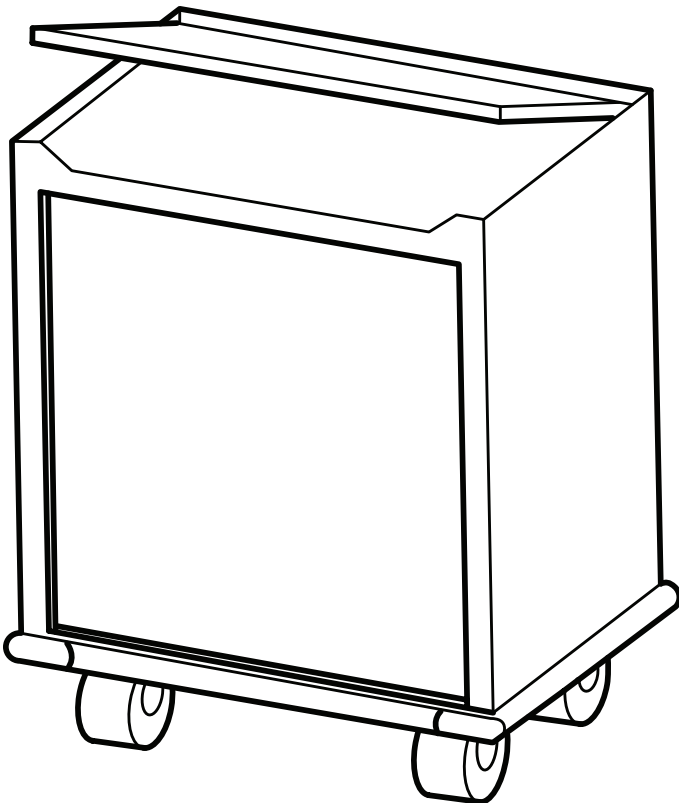

	GANA24HWMX
A	24" (60.8 cm)
B	0.79" (2.0 cm)
C	16.2" (41.1 cm)

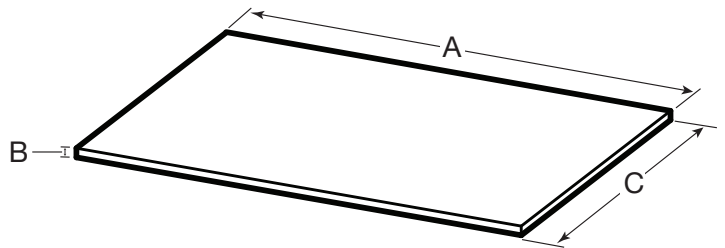

INSTALLATION INSTRUCTIONS

Worktop Use Requirements

- Intended for use with Gladiator® Flex 24" 2-Door Base Cabinet and Flex 24" 1-Drawer 2-Door Base Cabinet.
There are many benefits to registering your product. Find out more and register your product online at www.gladiatorgarageworks.com. Consumers in Canada can call: 1-800-807-6777

Install Worktop for Flex 24" 2-Door Base Cabinet

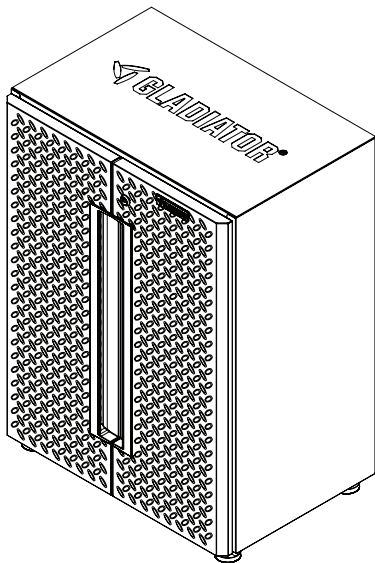

1. Unpack worktop and dispose of/recycle all packaging materials.
2. Position one Gladiator® Flex 24" 2-Door Base Cabinet without the mat.
NOTE: If you have installed casters on the cabinet, lock the casters.
3. Set the worktop onto the top of the cabinet.
NOTE: Ensure the locations of 4 nuts in the worktop match the holes in the cabinet's top.
4. Fix the worktop and the cabinet's top with 4 screws which were removed from the worktop.

Install Worktop for Flex 24" 2-Door Base Cabinet

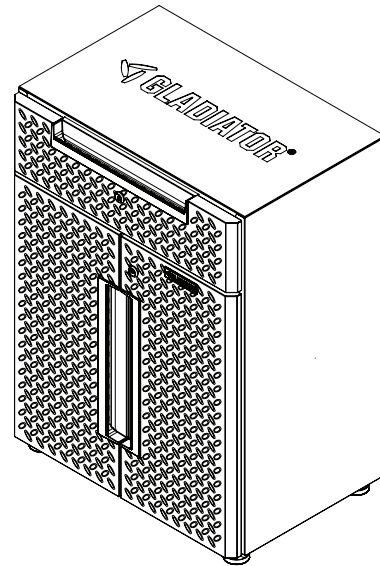

1. Unpack worktop and dispose of/recycle all packaging materials.
2. Position one Gladiator® Flex 24" 2-Door Base Cabinet without the mat.
NOTE: If you have installed casters on the cabinet, lock the casters.
3. Remove the drawer - Empty the drawer. Pull the drawer out so it's almost fully extended. There are two black release levers, one on each side of the drawer. Pull up the black release lever on one side, while pushing down the black release lever on the other side. While holding the levers in the positions as instructed below, pull the drawer outward until it is released from the drawer slides.

Push down – one side

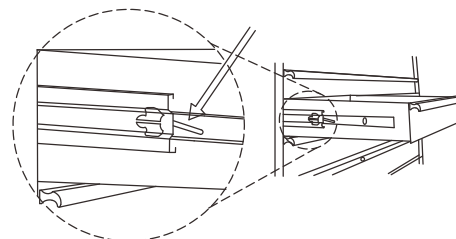

Pull up – other side

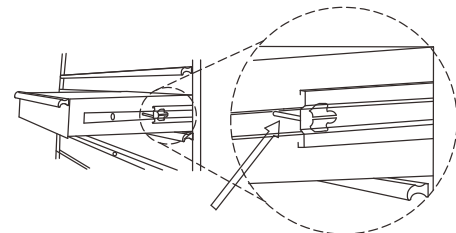

4. Set the worktop onto the top of the cabinet.
NOTE: Ensure the locations of 4 nuts in the worktop match the holes in the cabinet's top.
5. Fix the worktop and the cabinet's top with 4 screws which were removed from the worktop.

6. Install the drawer back - Extend the drawer slides from the cabinet. Insert the brackets on each side of the drawer into the slots in the slides, being careful that they are properly positioned. Once properly inserted, completely close the drawer to set the slides in their proper positions.

WARRANTY

For warranty information:

In the U.S.A. call **1-866-342-4089** or visit our website at

www.gladiatorgarageworks.com

In Canada call **1-800-807-6777** or visit our website at

www.gladiatorgarageworks.ca

SÉCURITÉ DU PLAN DE TRAVAIL

Your safety and the safety of others are very important.

We have provided many important safety messages in this manual and on your appliance. Always read and obey all safety messages.



This is the safety alert symbol.

This symbol alerts you to potential hazards that can kill or hurt you and others.

All safety messages will follow the safety alert symbol and either the word "DANGER" or "WARNING."

These words mean:

⚠ DANGER

You can be killed or seriously injured if you don't immediately follow instructions.

⚠ WARNING

You can be killed or seriously injured if you don't follow instructions.

All safety messages will tell you what the potential hazard is, tell you how to reduce the chance of injury, and tell you what can happen if the instructions are not followed.

DIMENSIONS

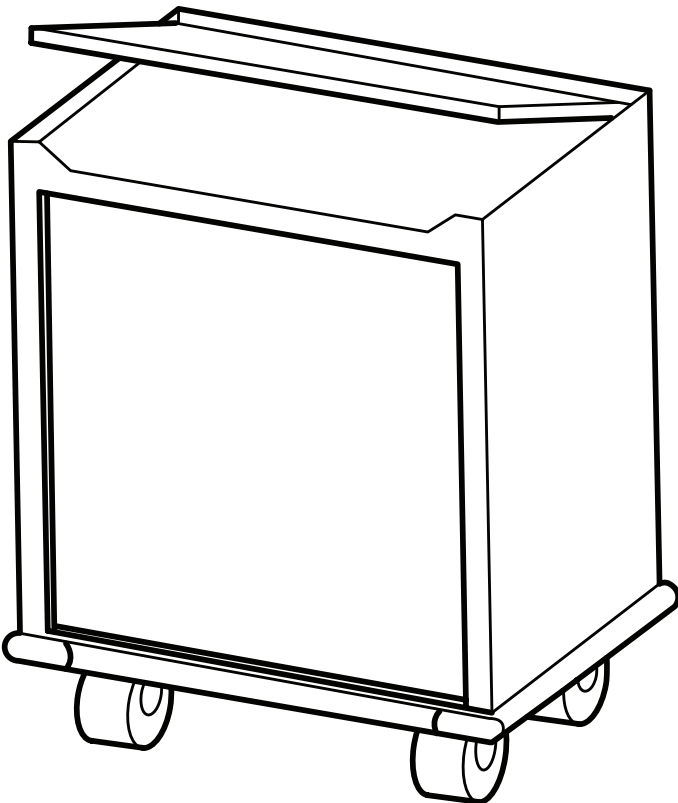

	GANA24HWMX
A	24 po (60,8 cm)
B	0,79 po (2,0 cm)
C	16,2 po (41,1 cm)

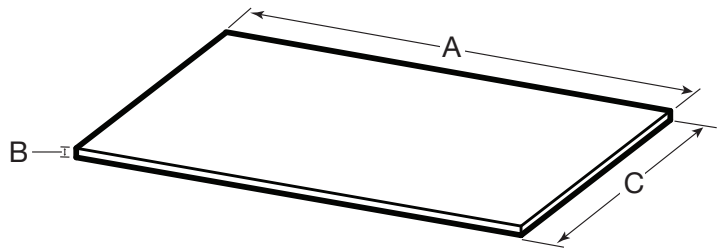

INSTRUCTIONS D'INSTALLATION

Spécifications d'utilisation du plan de travail

- Conçu pour être utilisé avec l'armoire du bas à 2 portes de 24 po Gladiator® Flex et l'armoire du bas à 1 tiroir et 2 portes de 24 po Flex.

L'enregistrement du produit présente de nombreux avantages. Pour obtenir plus de renseignements et enregistrer votre produit en ligne, consulter le

www.gladiatorgarageworks.com. Les clients canadiens peuvent appeler au : 1 800 807-6777

Installation du plan de travail pour armoire du bas à 2 portes de 24 po

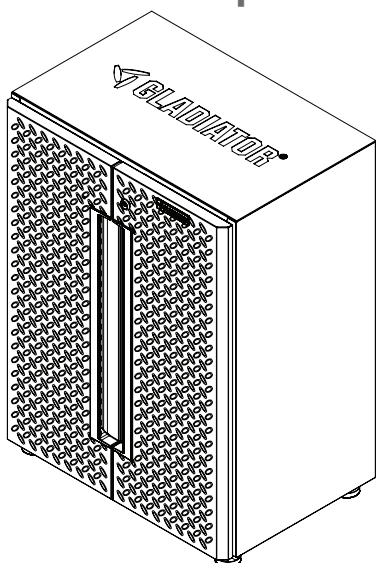

1. Déballez le plan de travail et jetez/recyclez tous les matériaux d'emballage.
2. Placer une armoire du bas à 2 portes de 24 po Gladiator® Flex sans le tapis.
REMARQUE : Si des roulettes ont été installées sur l'armoire, bloquer les roulettes.
3. Placer le plan de travail sur le dessus de l'armoire.
REMARQUE : S'assurer que l'emplacement des 4 écrous du plan de travail correspond aux trous sur le dessus de l'armoire.
4. Fixer le plan de travail sur l'armoire avec les 4 vis retirées du plan de travail.

Installation du plan de travail pour armoire du bas à 2 portes de 24 po

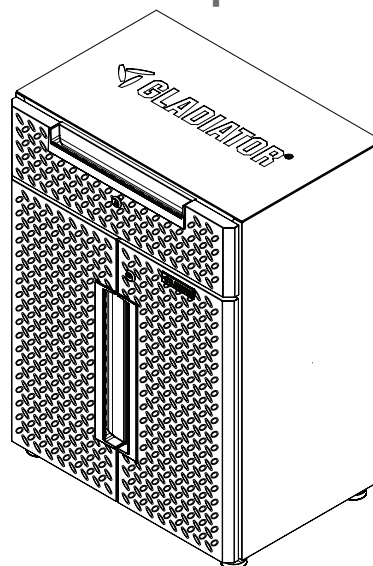

1. Déballez le plan de travail et jetez/recyclez tous les matériaux d'emballage.
2. Placer une armoire du bas à 2 portes de 24 po Gladiator® Flex sans le tapis.
REMARQUE : Si des roulettes ont été installées sur l'armoire, bloquer les roulettes.
3. Retirer le tiroir – Vider le tiroir. Tirer le tiroir pour l'ouvrir presque complètement. Il y a deux leviers de dégagement noirs, un de chaque côté du tiroir. Tirer vers le haut le levier d'un côté tout en poussant vers le bas le levier de l'autre côté. Tout en tenant les leviers dans ces positions, tirer le tiroir vers l'extérieur jusqu'à ce qu'il soit dégagé des glissières de tiroir.

Pousser vers le bas sur un côté

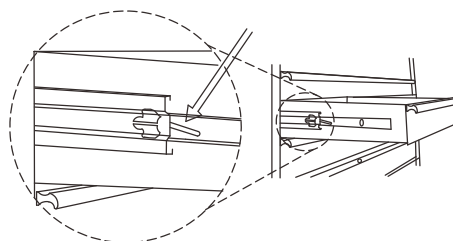

Tirer vers le haut sur l'autre côté

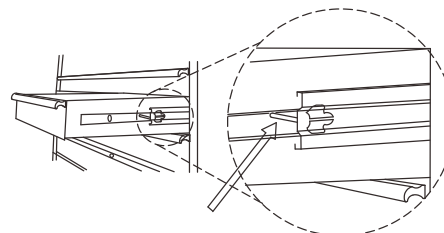

4. Placer le plan de travail sur le dessus de l'armoire.
REMARQUE : S'assurer que l'emplacement des 4 écrous du plan de travail correspond aux trous sur le dessus de l'armoire.

5. Fixer le plan de travail sur l'armoire avec les 4 vis retirées du plan de travail.
6. Réinstallation du tiroir – Sortir les glissières de tiroir de l'armoire. Insérer les supports de chaque côté du tiroir dans les fentes des glissières en faisant attention de bien les positionner. Une fois bien insérés, fermer complètement le tiroir pour remettre les glissières dans leur bonne position.

GARANTIE

Pour des informations sur la garantie :

Aux États-Unis, composer le **1-866-342-4089** ou visiter notre site Web à l'adresse **www.gladiatorgarageworks.com**

Au Canada, composer le **1 800 807-6777** ou visiter notre site Web à l'adresse **www.gladiatorgarageworks.ca**

SEGURIDAD DE LA ENCIMERA

Your safety and the safety of others are very important.

We have provided many important safety messages in this manual and on your appliance. Always read and obey all safety messages.



This is the safety alert symbol.

This symbol alerts you to potential hazards that can kill or hurt you and others.

All safety messages will follow the safety alert symbol and either the word "DANGER" or "WARNING."

These words mean:

⚠ DANGER

You can be killed or seriously injured if you don't immediately follow instructions.

⚠ WARNING

You can be killed or seriously injured if you don't follow instructions.

All safety messages will tell you what the potential hazard is, tell you how to reduce the chance of injury, and tell you what can happen if the instructions are not followed.

MEDIDAS

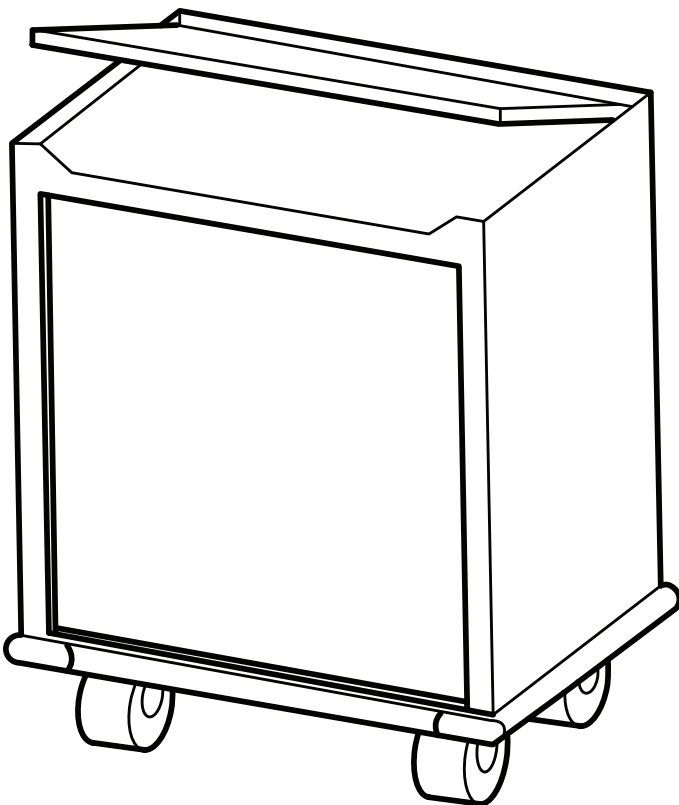

	GANA24HWMX
A	24" (60,8 cm)
B	0.79" (2,0 cm)
C	16.2" (41,1 cm)

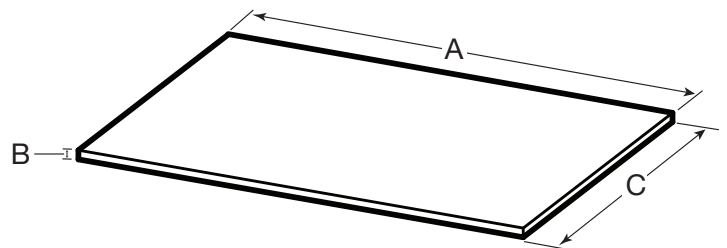

INSTRUCCIONES DE INSTALACIÓN

Requisitos para el uso de la encimera

- Destinado al uso con el gabinete base Flex de 24" con 2 puertas y el gabinete base Flex de 24" con 1 cajón y 2 puertas de Gladiator®.

Registrar el producto ofrece muchos beneficios. Obtenga más información y registre el producto en línea en

www.gladiatorgarageworks.com. Los consumidores en Canadá pueden llamar al: 1-800-807-6777

Instale la encimera para el gabinete base Flex 24" de 2 puertas

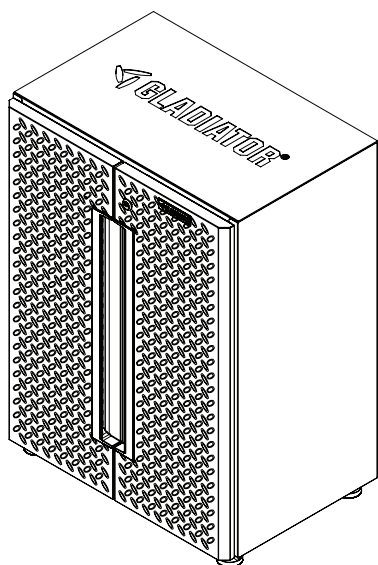

1. Desempaque la encimera y deseche/recicle todos los materiales de embalaje.
2. Coloque un gabinete base Flex de 24" con 2 puertas Gladiator® sin la alfombrilla.
NOTA: Si instaló ruedecillas en el gabinete, trábelas.
3. Coloque la encimera sobre la parte superior del gabinete.
NOTA: Asegúrese de que las ubicaciones de 4 tuercas en la encimera coinciden con los orificios en la parte superior del gabinete.
4. Fije la encimera y la parte superior del gabinete con los 4 tornillos que se retiraron de la encimera.

Instale la encimera para el gabinete base Flex 24" de 2 puertas

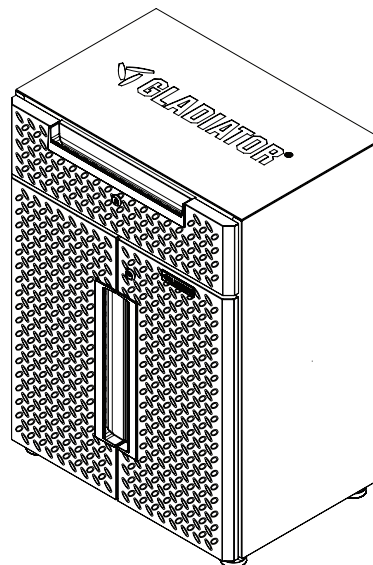

1. Desempaque la encimera y deseche/recicle todos los materiales de embalaje.
2. Coloque un gabinete base Flex de 24" con 2 puertas Gladiator® sin la alfombrilla.
NOTA: Si instaló ruedecillas en el gabinete, trábelas.
3. Saque el cajón y vacíelo. Tire del cajón hasta que esté casi completamente extendido. Hay dos palancas negras de apertura, una a cada lado del cajón. Tire hacia arriba de la palanca de desbloqueo negra de un lado, mientras empuja hacia abajo la palanca de desbloqueo negra del otro lado. Mientras mantiene las palancas en las posiciones indicadas a continuación, tire del cajón hacia fuera hasta que se libere de las guías del cajón.

Empuje hacia abajo - un lado

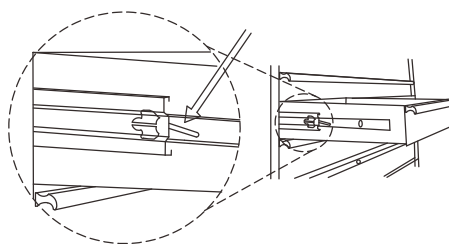

Tire hacia arriba - el otro lado

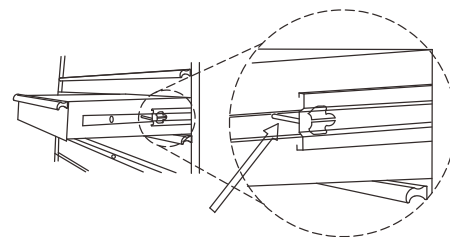

4. Coloque la encimera sobre la parte superior del gabinete.
NOTA: Asegúrese de que las ubicaciones de 4 tuercas en la encimera coinciden con los orificios en la parte superior del gabinete.

5. Fije la encimera y la parte superior del gabinete con los 4 tornillos que se retiraron de la encimera.
6. Vuelva a instalar el cajón, extienda las guías del cajón desde el gabinete. Introduzca los soportes de cada lado del cajón en las ranuras de las guías, teniendo cuidado de que estén bien colocados. Una vez insertado correctamente, cierre completamente el cajón para colocar las guías en su posición correcta.

GARANTÍA

Para obtener información sobre la garantía:

En EE. UU., llame al **1-866-342-4089** o visite nuestro sitio web en **www.gladiatorgarageworks.com**

En Canadá, llame al **1-800-807-6777** o visite nuestro sitio web en **www.gladiatorgarageworks.ca**